



Warman High School In-Town Busing

Warman in-town busing is offered to Warman High School students, based on their distance from the school. The Prairie Spirit Board of Education determined the criteria for in-town busing in the Town of Warman. In-town busing is only available for those Warman High School students living within the boundaries shown on the following maps.

Only new students to Warman High School (including those students transferring from Warman Elementary School) will need to complete a bus transportation request form.

Warman in-town bus transportation request forms are available on the Prairie Spirit [website](#) or at the Division Office at 121 Klassen Street East, Warman. Once the request form is completed and processed, the student will be given a bus pass.

Only students with bus passes will be allowed to ride the bus. The bus pass details the number of the bus route determined for the student (see following maps for clarification); the student must get on the bus at that particular bus stop.

2010/11 School Year

A new high school bus stop (#9) has been added at the corner of Nicklaus Drive and Nicklaus Gate (south side) for Grade 6 - 12 students who live north of an east/west line drawn down the middle of the north portion of Faldo Crescent and Watson Way west to Centennial Boulevard (Bus #289: leave time: 8:26 a.m.; drop off time: 3:21 p.m.).

There has been an adjustment in times for the #1 bus stop (leave time: 8:17 a.m.; drop off time: 3:28 p.m.) and #5 bus stop (leave time: 8:20 a.m.; drop off time: 3:31 p.m.).

Contacts:

Grant Drever, Conveyance Manager
374-2496

Nancy Matechuk, Executive Assistant
374-2496

Prairie Spirit School Division
Box 809, 121 Klassen Street East
Warman, SK S0K 4S0
683-2880
www.spiritsd.ca

Warman High In-Town Bus Stop Times

Monday, Tuesday, Wednesday, Thursday A.M., and Friday

PLEASE NOTE: *Thursday P.M. bus times will be one hour earlier due to early dismissal.*

Stop No.	Bus No.	Driver	Leave Time	Drop-Off Time	Address
1	289	Ed Hamm	8:12 a.m.	3:28 p.m.	104 Crystal Springs Drive
2	290	Abe Giesbrecht	8:20 a.m.	3:11 p.m.	Brooklyn Crescent and Brooklyn Gate (south side)
3	290	Abe Giesbrecht	8:26 a.m.	3:15 p.m.	Green space on Brookside Drive (west side)
4	287	Doug Arnold	8:20 a.m.	3:28 p.m.	408 Crystal Bay
5	289	Ed Hamm	8:15 a.m.	3:31 p.m.	Alley entrance across from 532 Crystal Crescent (west side)
6	287	Doug Arnold	8:25 a.m.	3:31 p.m.	Alley entrance across from 612 – 4 th St. W. (south side)
7	290	Abe Giesbrecht	8:41 a.m.	3:30 p.m.	Alley entrance across from 552 Ens Crescent (east side)
8	290	Abe Giesbrecht	8:37 a.m.	3:26 p.m.	Alley entrance between 242 – 1 st Ave. N. and 527 Murray Crescent on 1 st Ave. N. (east side)
9	289	Ed Hamm	8:21 a.m.	3:21 p.m.	Corner of Nicklaus Drive and Nicklaus Gate (south side)

High school bus stops will be:

1. 104 Crystal Springs Dr.
2. Brooklyn Cres. and Brooklyn Gates (south side)
3. Green space on Brookside Dr. (west side)
4. 408 Crystal Bay
5. Alley entrance across from 532 Crystal Crescent (west side)
6. Alley entrance across from 612 - 4th St. W. (south side)
7. Alley entrance across from 552 Ens Crescent (east side)
8. Alley entrance between 242 - 1st Ave. N. and 527 Murray Cres. on 1st Ave. N. (east side)

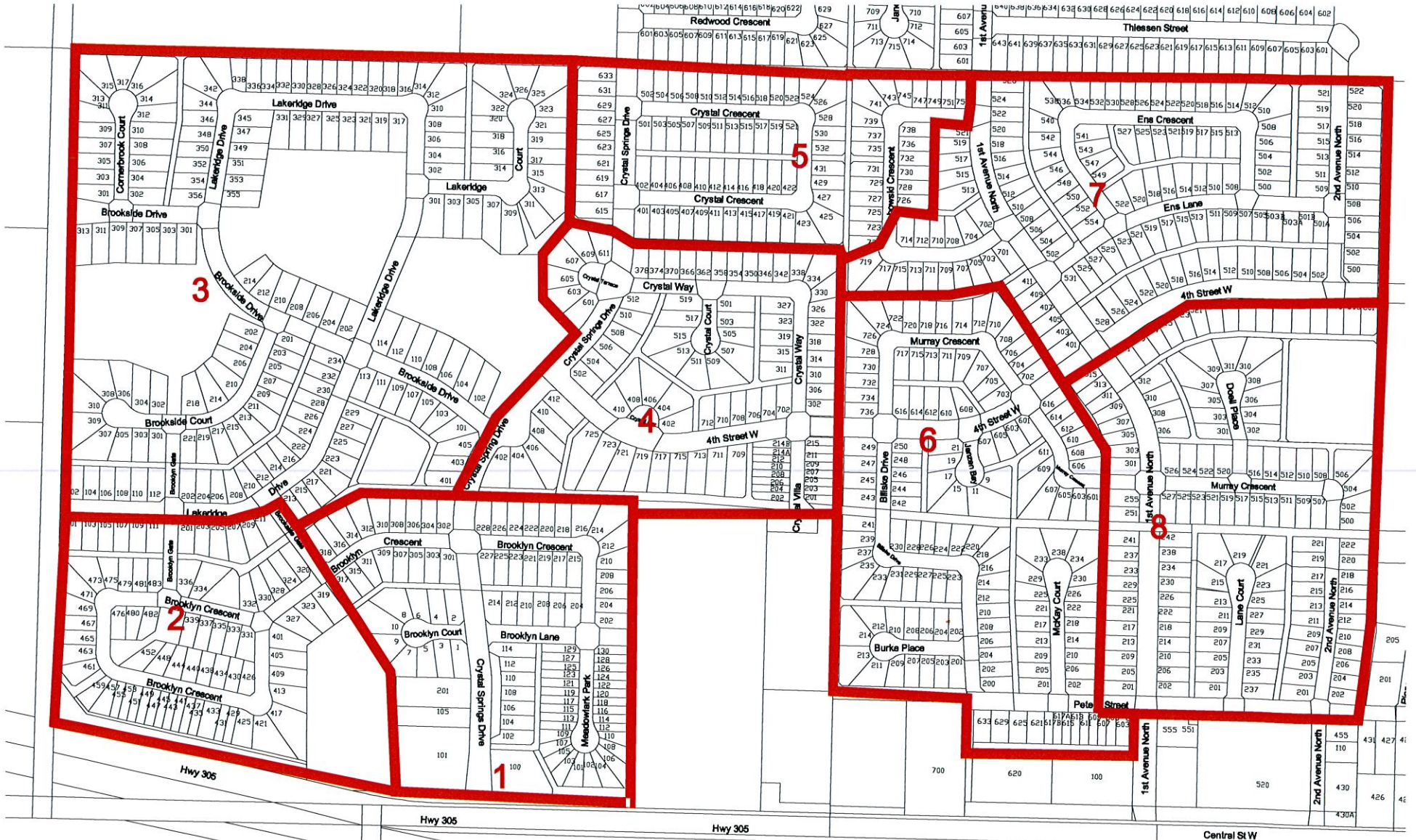

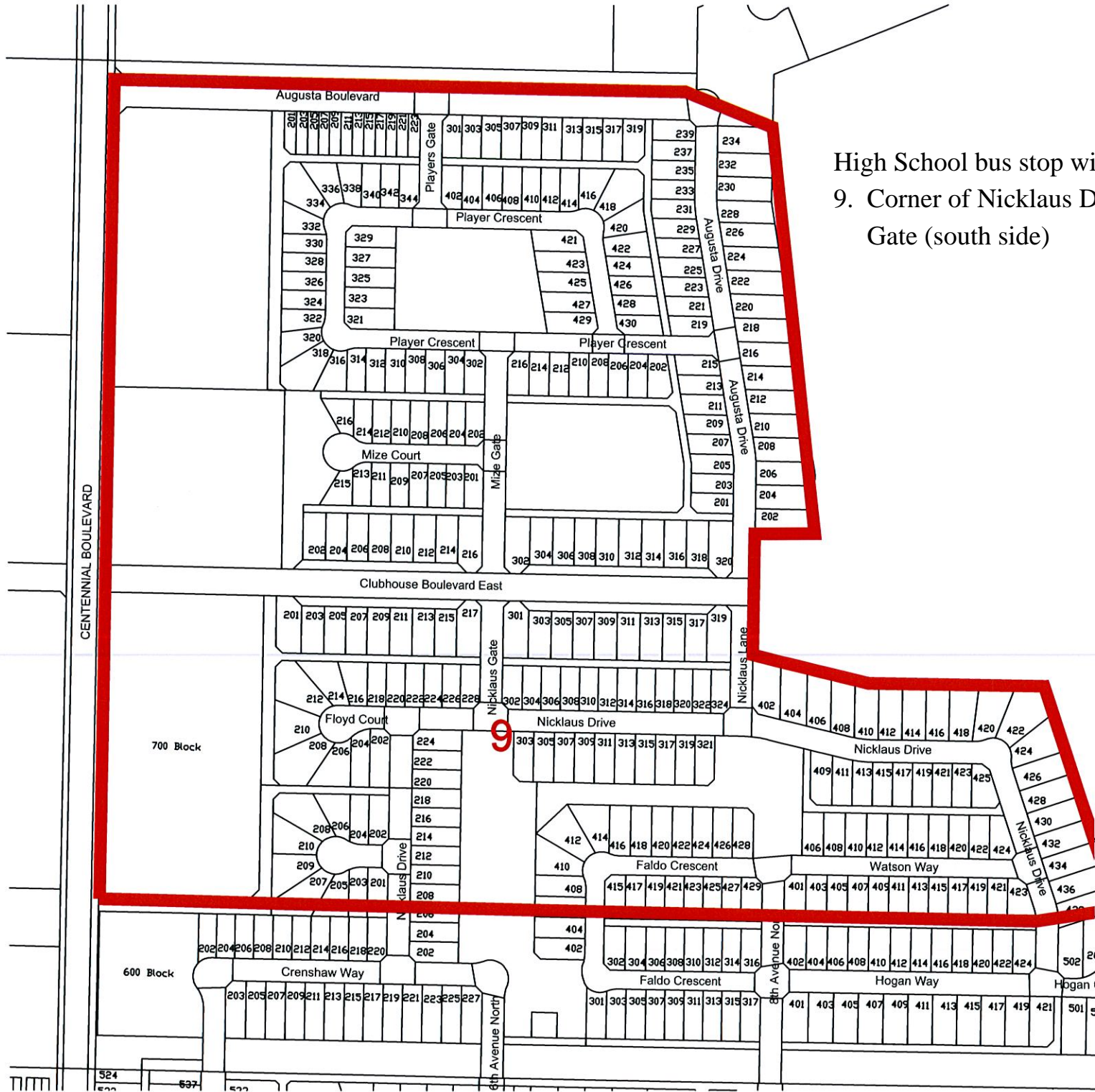

High School bus stop will be:
 9. Corner of Nicklaus Dr. and Nicklaus Gate (south side)

9